

Type MA 210

2-way solenoid valve
direct actuated, NC
(normally closed)

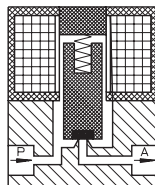

Application
Neutral liquids, gases
and vapors

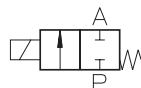

Type/ Order No.	Orifice [mm]	Port size	Pressure range [bar]		kv-value [m³/h]	Weight [kg]
			AC	DC		
MA 210-001	0,8	M 5	-	0 - 8	0,02	0,050
MA 210-002	1,0	M 5	-	0 - 6	0,03	0,050
MA 210-003	1,2	M 5	-	0 - 5	0,04	0,050
MA 210-004	1,6	M 5	-	0 - 2	0,06	0,050
MA 210-005	2,0	M 5	-	0 - 1	0,08	0,050

Sealing material: **P** (NBR) **E** (EPDM) **V** (FPM)

Body material: Brass
 Inner parts: Stainless steel (1.4105)
 Mounting direction: Free, preferred upwards
 Max. ambient temp.: 50 °C
 Viscosity of the medium: max. 21 mm²/s (3 °E)
 Static pressure: max. 10 bar
 Standard voltage: DC: 24, 12 V

Power consumption: 1 W
 Voltage tolerance: -15%... +10%
 Duty cycle: 100%
 Operating frequency: max. 1800/min
 Degree of Protection: IP 54 (EN 60529)

Other configurations upon request

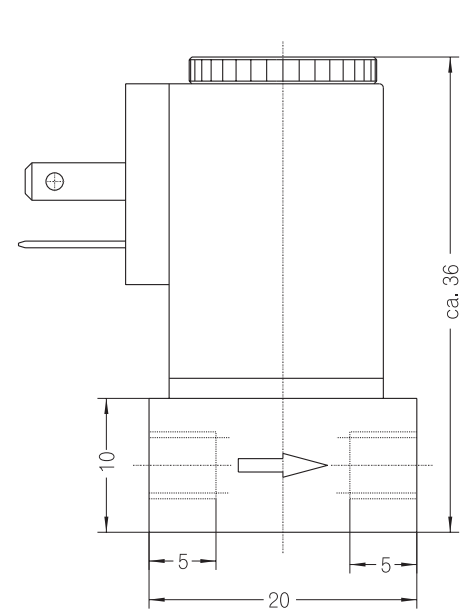

The right to modification is reserved

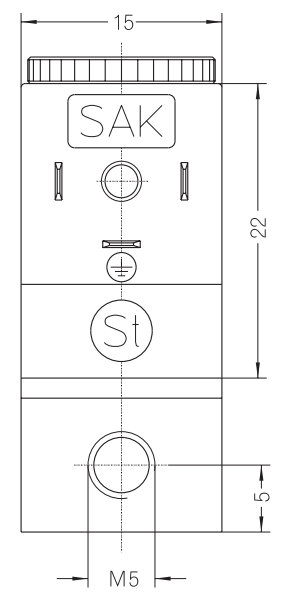

Dimensions in mm